

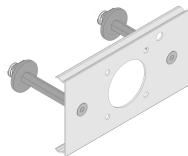

Product data sheet

53050/LED - Plug-in cover CEE 16A 3p LED ws BRK 4675



made of aluminum profile 1.7mm for socket CEE 16A 3P type 63 and punching for LED voltage indicator, including extension bolt and fixing material. Color: RAL 9010 Pure white Length 150mm

Characteristics	
Base Unit	Piece
availability	Delivery according to agreement
group	284000
Packaging unit	1
country of origin	CH
Weight (g)	180 g



## **Product data sheet**

53050/LED - Plug-in cover CEE 16A 3p LED ws BRK 4675

### **Product accessories**



## Product data sheet

53050/LED - Plug-in cover CEE 16A 3p LED ws BRK 4675

### Product systems

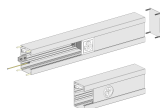

#### Parapet trunking system BRK 4675 140x90

Parapet channel 4675 140x90 mm. Often used for the development of MVE 4675.

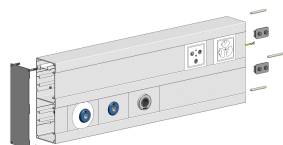

#### Parapet trunking system BRK 4675 250x90

Media channel BRK 4675 250x90 mm



#### Parapet trunking system BRK 4675 180x90

Parapet trunking system BRK 4675 180x90 - with combination rail - made of aluminum profile - front opening

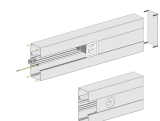

#### Parapet channel BRK 4675 200x90

Parapet channel 4675 200x90 mm. Often used for the development of MVE 4675.



#### Parapet trunking system BRK 4675 250x90

Parapet trunking system BRK 4675 200x90 - with two chambers - with combination rail - made of aluminum profile - openings in front

