

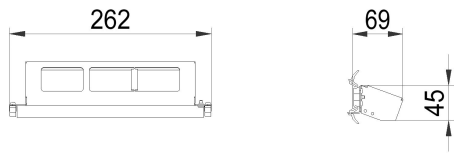

Product data sheet

59514 - Installation kit Scs 3FLF horizontal empty KDK



Low-current version for KDK with hinged cover on top
made of sendzimir-galvanized sheet steel
with 2 clamps for snapping onto DIN-35 rail
for installation of FLF 3/5 apparatus
color: raw

Characteristics	
Base Unit	Piece
availability	Delivery according to agreement
group	284000
Packaging unit	1
country of origin	CH
Customs tariff number	7308.9000
Weight (g)	342 g



Product data sheet

59514 - Installation kit Scs 3FLF horizontal empty KDK

Product accessories



Product data sheet

59514 - Installation kit Scs 3FLF horizontal empty KDK

Product systems

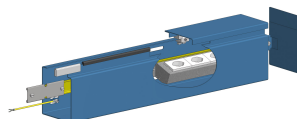

Hinged cover channel system KDK 150x115

Hinged cover channel 150x115 mm.

