



System overview

FE180 E30/E90 3G2.5 mm²



Woertz Fire Safety System FE180 E30/E90 3G2.5 mm² for power supply of safety-relevant elements, such as emergency and escape route lighting, smoke extraction systems or fire department elevators.

Components



48250OR - Flat cable FE180/E90 3G2.5 orange

Flat cable Woertz FE180/E30/E90 3x2.5 mm² FR/LS0H orange LNPE (rodent repellent) Fire protection cable with non-critical behavior (according to VKF guideline 14-15) for use in horizontal and vertical escape routes. Applicable in public buildings and facilities such as hospitals, hotels, offices, museums or other commercial buildings (KBOB). Also recommended for facilities with increasing numbers of people in increasingly confined spaces such as airports, train stations (above and below ground) or shopping malls (KBOB). Within the Woertz fire protection cabling systems also ideally suited for the high demands of infrastructure buildings such as tunnels, underpasses, parking garages or subway stations.



48250GE - Câble plat FE180/E90 3G2.5 yellow

Flat cable Woertz FE180/E30/E90 3x2.50mm 2 FR/LS0H yellow LNPE (rodent repellent). Fire protection cable with non-critical behavior (according to VKF guideline 14-15) for use in horizontal and vertical escape routes. Applicable in public buildings and facilities such as hospitals, hotels, offices, museums or other commercial buildings (KBOB). Also recommended for facilities with an increasing number of people in ever tighter spaces such as airports, train stations (above and below ground) or shopping malls (KBOB). Within the Woertz fire protection cabling systems also ideally suited for the high demands of infrastructure buildings such as tunnels, underpasses, parking garages or subway stations.



48253 - Junction box FK E90 3G2.5 M20 Ø 6-15

Fire safety box IP66/IP68, 2-screw contacting for stripping-free feeding and branching, with screw connection for heavy current 3G2.5 mm², lengthwise outgoing, incl. 3 x cable glands M20x1.5, with a clamping range of Ø 6-8 mm, Ø 8-11 mm and Ø 11-15 mm respectively



48253/01 - Junction box FK E90 3G2.5 M20 Ø 6-8 mm







Fire safety box IP66/IP68, 2-screw contacting for stripping-free feeding and branching, with screw connection for heavy current 3G2.5 mm², lengthwise outgoing, incl. 1 x cable gland M20x1.5, with a clamping range of Ø 6-8 mm





System overview

FE180 E30/E90 3G2.5 mm²

	<p>48253/02 - Box FC E90 3G2.5 junction M20 D:8-11</p> <p>Fire safety box IP66/IP68, 2-screw contacting for stripping-free feeding and branching, with screw connection for heavy current 3G2.5 mm², lengthwise outgoing, incl. 1 x cable gland M20x1.5, with a clamping range of Ø 8-11 mm</p>	
	<p>48253/03 - Junction box FK E90 3G2.5 M20 Ø 11-15 mm</p> <p>Fire safety box IP66/IP68, 2-screw contacting for stripping-free feeding and branching, with screw connection for heavy current 3G2.5 mm², lengthwise outgoing, incl. 1 x cable gland M20x1.5, with a clamping range of Ø 11-15 mm</p>	
	<p>48253/SI - Box FC E90 3G2.5 with fuse</p> <p>Fire safety box with fuse adapter IP66/68 for flat cable FE180 E90 3G2.5 mm² incl. 3 x cable gland M20x1.5, with a clamping range of Ø 6-8 mm, Ø 8-11 mm and Ø 11-15 mm respectively Project-specific design on request see document/G00'299</p>	
	<p>48960 - Junction box FK E90 3G2.5/3G4.0 IP68 with shrink tubing</p> <p>Feed/connection box E90, for feeding (round cable - flat cable) or for connection (flat cable - flat cable) for flat cable 3G2.5/4 mm². With heat shrink tubing IP66/68.</p>	
	<p>48961 - End caps FC E90 3G2.5/3G4.0/3G6.0</p> <p>End caps E90 IP66/68 for flat cable FE180 E90 3G2.5mm 2 /3G4.0mm 2 /3G6.0mm 2</p>	
	<p>48510/08 - Cable end piece for FK power IP 5G2.5mm² FE180 3G2.5mm²</p> <p>Cable end piece for flat cable power IP68 and FE180 3/5G</p>	
	<p>48510/08/NS - Flat cable end piece 5G2.5mm² FE180 E30/E90 3G2.5mm²</p> <p>null</p>	
	<p>49935 - Cutting shears up to 6 mm²</p> <p>Woertz flat cable shears up to 5x6 mm² (with higher force up to 5x16 mm²)</p>	
	<p>49370 - Fixing clamp 3G2.5/4 mm² E90</p> <p>Mounting distance: 800mm</p>	



System overview

FE180 E30/E90 3G2.5 mm²



49386 E90 - Riser clamp E90

Max. Bride load: 50kg. For Woertz fire safety flat cable: Woertz FE180 3G2.5 and 4 mm², Woertz FE180 5G2.5, 4 6 mm². For Woertz flat cable: Woertz Technofil 5G2.5 1.5 mm², Woertz power 5G2.5 mm², Woertz Power IP 5G2.5 mm² 6 mm², Woertz combi 5G2.5 mm² 2x1.5 mm², Woertz Dali IP 5G2.5 mm² 2x1.5 mm², Woertz Dali 3/5G2.5 mm² 2x1.5 mm², Woertz 5G4 mm², Woertz 7G2.5 mm².

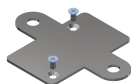

48254 - Retaining plate to box 48253/48453

Retaining plate to connection box 48253/48453

