

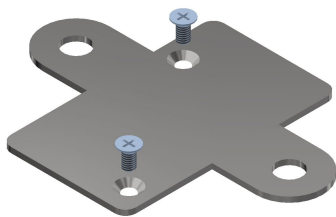

Product data sheet

48254 - Retaining plate to box 48253/48453



Retaining plate to connection box 48253/48453

Characteristics	
Base Unit	Piece
availability	Delivery according to agreement
group	170000
Packaging unit	1
country of origin	CH
Customs tariff number	7226.9900
Weight (g)	78 g



## **Product data sheet**

48254 - Retaining plate to box 48253/48453

### **Product accessories**



## Product data sheet

48254 - Retaining plate to box 48253/48453

### Product systems



#### **FE180 E30/E90 3G4 mm<sup>2</sup>**

Woertz fire safety system FE180 E30/E90 3G4 mm<sup>2</sup> for power supply of safety-relevant elements, such as emergency and escape route lighting, smoke extraction systems or fire department elevators.



#### **FE180 E30/E90 3G2.5 mm<sup>2</sup>**

Woertz Fire Safety System FE180 E30/E90 3G2.5 mm<sup>2</sup> for power supply of safety-relevant elements, such as emergency and escape route lighting, smoke extraction systems or fire department elevators.

