

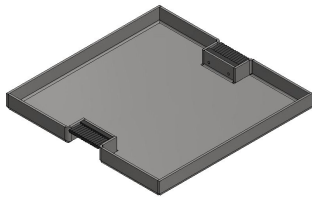

Product data sheet

51530 - Cr lid with rim BAK/DAK22 BL



made of chrome steel 3mm
with edge height 22mm
including 2 pcs. Brush outlets

Characteristics	
Base Unit	Piece
availability	Delivery according to agreement
group	282000
Packaging unit	1
country of origin	CH
Weight (g)	738 g



Product data sheet

51530 - Cr lid with rim BAK/DAK22 BL

Product accessories



Product data sheet

51530 - Cr lid with rim BAK/DAK22 BL

Product systems

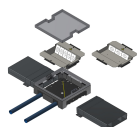

Floor junction box BAK22 200x40

Underfloor system with square plenum box and chrome steel and aluminum junction boxes, edge height 22mm for UFK 200x40 underfloor duct.

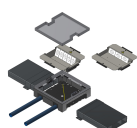

Floor junction box BAK22 200x50

Underfloor system with square plenum box and chrome steel and aluminum junction boxes, edge height 22mm for UFK 200x50 underfloor duct.

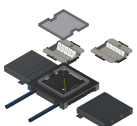

Floor junction box BAK22 300x40

Underfloor system with square plenum box and chrome steel and aluminum junction boxes, edge height 22mm for UFK 300x40 underfloor duct.

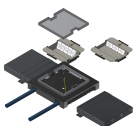

Floor junction box BAK22 300x50

Underfloor system with square plenum box and chrome steel and aluminum junction boxes, edge height 22mm for UFK 300x50 underfloor duct.

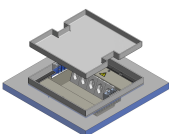

DAK22 271x271 square

Raised floor system DAK22 271x271 square.

