

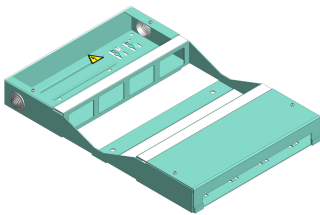















System overview

Raised floor junction box for mounting on the bare floor



Various junction boxes for raised floor system DAK for mounting on the bare floor.
Special designs and wiring on request.

Components

	<p>52863 - Terminal box 2x3FLF horizontal empty DAK</p> <p>made of galvanized steel sheet 1.5mm dimensions: 410x210x45mm color: RAL 6027 light green</p>	
	<p>52864 - Terminal box 2x4FLF horizontal empty DAK</p> <p>made of galvanized steel sheet 1.5mm dimensions: 410x275x45mm color: RAL 6027 light green</p>	
	<p>52865 - Terminal box 2x5FLF horizontal empty DAK</p> <p>made of galvanized steel sheet 1.5mm dimensions: 410x340x45mm color: RAL 6027 light green</p>	
	<p>52866 - Terminal box 2x6FLF horizontal empty DAK</p> <p>made of galvanized steel sheet 1.5mm dimensions: 410x405x45mm color: RAL 6027 light green</p>	
	<p>52874 - Junction box 2x4FLF vertical empty DAK</p> <p>made of galvanized steel sheet 1.5mm dimensions: 480x169x73mm color: RAL 6027 light green</p>	
	<p>52875 - Junction box 2x5FLF vertical empty DAK</p> <p>made of galvanized steel sheet 1.5mm dimension: 480x207x73mm color: RAL 6027 light green</p>	
	<p>52876 - Junction box 2x6FLF vertical empty DAK</p> <p>made of galvanized steel sheet 1.5mm dimensions: 480x245x73mm color: RAL 6027 light green</p>	



System overview

Raised floor junction box for mounting on the bare floor

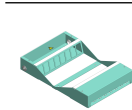

52878 - Junction box 2x8FLF vertical empty DAK

made of galvanized steel sheet 1.5mm dimensions: 480x321x73mm color: RAL 6027 light green

