

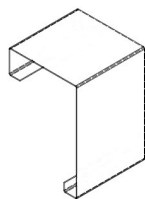

Product data sheet

58765 - End piece left edge white KDK 220x150



End piece version left for hinged cover trunking KDK 220x150, open at the side made of galvanized sheet steel 1.5mm
Color: RAL 9010 Pure white
Length: 125 mm

Characteristics	
Base Unit	Piece
availability	Delivery according to agreement
group	999000
Packaging unit	1
country of origin	CH
Technical data	
Nominal mass	220x150



Product data sheet

58765 - End piece left edge white KDK 220x150

Product accessories



Product data sheet

58765 - End piece left edge white KDK 220x150

Product systems

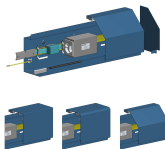

Hinged cover channel system KDK 220x150

Hinged cover channel 200x150 mm

