

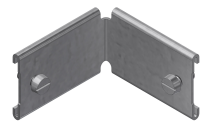

Product data sheet

53539 - Connector IG 90° for DIN rail



for connecting the channel shell for DIN-35 rail with 90° inside miter

Characteristics	
Base Unit	Piece
availability	Delivery according to agreement
group	284000
country of origin	CH
Weight (g)	45 g



## **Product data sheet**

53539 - Connector IG 90° for DIN rail

### **Product accessories**



## Product data sheet

53539 - Connector IG 90° for DIN rail

### Product systems

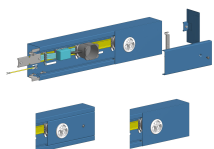

#### Parapet trunking system BRK 4671 140x79

Parapet trunking 4671 140x79mm - With DIN 35 rail - Made of galvanized sheet steel. Openings at the front

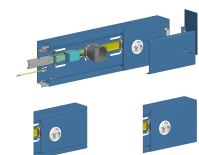

#### Parapet trunking system BRK 4671 182x79

Parapet trunking 4671 182x79 mm - With DIN 35 rail - Made of galvanized sheet steel. Openings at the front

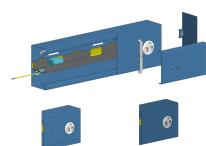

#### Parapet trunking system BRK 4183 182x97

Parapet trunking 4183 182x97 mm with DIN 35 rail - Made of galvanized sheet steel. Openings at the bottom.

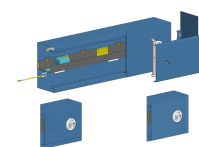

#### Parapet trunking system BRK 4183 200x115

Parapet trunking 4183 200x115 mm with DIN 35 rail - Made of galvanized sheet steel. Openings at the bottom.

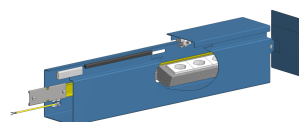

#### Hinged cover channel system KDK 150x115

Hinged cover channel 150x115 mm.

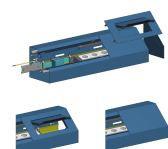

#### Plinth trunking system SOK 4181 160x160

Socket channel SOK 4181 160x160 mm. Sockets accessible via brush outlet.

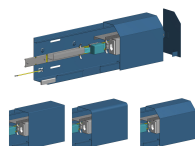

#### Combination trunking system KOK 200x120

Combination duct KOK 200x120 mm.





Product data sheet

53539 - Connector IG 90° for DIN rail

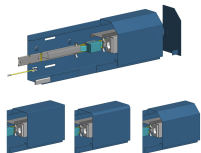

**Combination trunking system KOK 200x120 as base trunking**

Combination trunking KOK 200x120 mm as base trunking. With suspension cover.

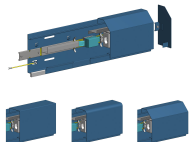

**Combination trunking system KOK 180x90 as base trunking**

Combination trunking KOK 180x90 mm as base trunking. With suspension cover.

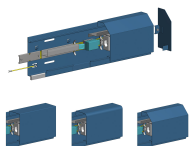

**Combination trunking system KOK 180x90**

Combination duct KOK 180x90 mm.

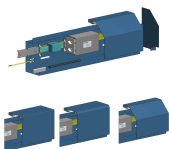

**Hinged cover channel system KDK 200x130**

Hinged cover channel 200x130 mm

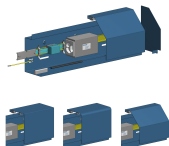

**Hinged cover channel system KDK 220x150**

Hinged cover channel 200x150 mm

