

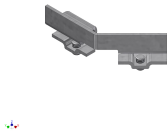

Product data sheet

53532 - Connecting link BRK AG135°



External miter 135° for BRK 4670, 4671, 4183

Characteristics	
Base Unit	Piece
availability	Delivery according to agreement
group	284000
Packaging unit	250
country of origin	CH
Customs tariff number	7308.9000
Weight (g)	44 g



Product data sheet

53532 - Connecting link BRK AG135°

Product accessories



Product data sheet

53532 - Connecting link BRK AG135°

Product systems

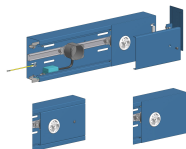

Parapet trunking system BRK 4670 182x85

Parapet channel 4670 182x85 mm - With stable anchor rail C30 for fastening with slot nut. - Made of galvanized sheet steel. Openings at the front.

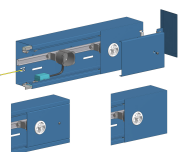

Parapet trunking system BRK 4670 200x115

Parapet channel 4670 200x115 mm. With stable anchor rail C30 for fastening with slot nut. - Made of galvanized sheet steel. Openings at the front.

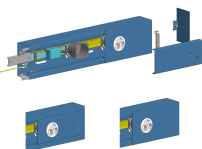

Parapet trunking system BRK 4671 140x79

Parapet trunking 4671 140x79mm - With DIN 35 rail - Made of galvanized sheet steel. Openings at the front

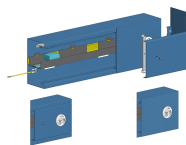

Parapet trunking system BRK 4183 200x115

Parapet trunking 4183 200x115 mm with DIN 35 rail - Made of galvanized sheet steel. Openings at the bottom.

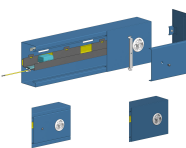

Parapet trunking system BRK 4183 182x97

Parapet trunking 4183 182x97 mm with DIN 35 rail - Made of galvanized sheet steel. Openings at the bottom.

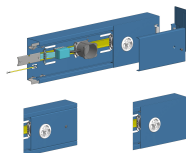

Parapet trunking system BRK 4671 182x79

Parapet trunking 4671 182x79 mm - With DIN 35 rail - Made of galvanized sheet steel. Openings at the front

