

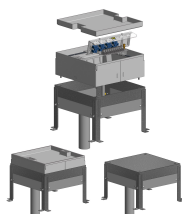

## System overview

### Floor junction box BAK22 to slab formwork



Plenum box BAK22 for fastening to the slab formwork.

The installation of underfloor ducts requires a minimum height of the concrete overlay (60 mm). If this height is not available, special boxes can be obtained for concreting into the raw slab. After fastening to the formwork, they are connected to each other with underfloor trunking 200 x 40, covered with the temporary protective cover and cast in the concrete up to the top edge.

The installation kit is mounted on the levelable box insert; the opening between the box bottom and the installation plate allows the cable to pass through to the next box. After finished wiring, an aluminum cover with cable trough is attached.

Connection box consisting of:

- Enclosure with adjustable feet, with four side openings 202 x 42 mm and a bottom entry tube M50 with temporary one-way steel cover incl. 4 screws
- Enclosure insert made of aluminum, with frame 278 x 278
- Al cover with edge 22 mm
- 2 cable trays made of polycarbonate crystal clear with transparent filler piece

## Components



### 51770 - Plenum box BAK22 150-220 Al KM

Housing made of sendzimir galvanized sheet steel 2mm with adjustable feet and side openings 202x42 mm and floor insertion tube M50  
Adjustment range: 150-220mm  
Frame and cover made of aluminum 3mm with wooden cover as protection  
Edge height 22mm with 2 cable trays  
Adjustment range for UB finished floor: 30-90mm



### 51771 - Plenum box BAK22 200-270 Al KM











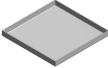

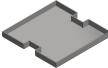
Housing made of sendzimir galvanized sheet steel 2mm with adjustable feet and side openings 202x42 mm and floor entry tube M50  
Adjustment range: 150-220mm  
Frame and cover made of aluminum 3mm with wooden cover as protection  
Edge height 22mm with 2 cable trays  
Adjustment range for UB finished floor: 30-90mm

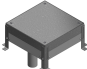

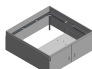

## System overview

### Floor junction box BAK22 to slab formwork

	<b>51564 - Al lid with rim 271 ZUG22</b> made of aluminum 3mm with edge height 22mm	
	<b>51565 - Al lid with rim BAK/DAK22 KM</b> made of aluminum 3mm with edge height 22mm for cable tray	
	<b>51762 - Housing BAK/DRAW 150-220 St</b> Housing made of sendzimir-galvanized sheet steel 2mm with adjustable feet and floor insertion tube M50 with temporary steel cover including screws Adjustment range: 150-220mm	
	<b>51763 - Housing BAK/PULL 200-270 St</b> Housing made of sendzimir-galvanized sheet steel 2mm with adjustable feet and floor insertion tube M50 with temporary steel cover including screws Adjustment range: 200-270mm	
	<b>51774 - Housing insert BAK22/ZUG22 Al</b> to BAK22, fixing to the ceiling formwork consisting of: Frame 278x278 of aluminum 3mm complete and screwed collar, height 72mm of sendzimir galvanized sheet steel 1.5mm  Available on request in chrome steel or brass	
	<b>52060 - Installation kit 2x3FLF horizontal empty BAK22</b> hook-in, to BAK with protective edge 12mm and 22mm made of galvanized sheet steel 1.5mm including 2 mounting plates color: RAL 7032 pebble gray equipped with: 1 pc. Terminal strip 7x2.5mm <sup>2</sup> minimum floor height: BAK12=74mm; BAK22=84mm	



## System overview

### Floor junction box BAK22 to slab formwork

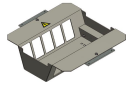

#### 52040 - Installation kit 2x5FLF vertical empty BAK22

hook-in, to BAK with protective edge 12mm and 22mm  
made of galvanized sheet steel 1.5mm  
including 2 mounting plates  
color: RAL 7032 pebble gray  
equipped with: 1 pc. Terminal strip 9x2.5mm<sup>2</sup>  
minimum floor height: BAK12=89mm; BAK22=99mm



#### 51111 - Brush strip BAK22 / DAK22 / WAK 214

plastic black  
Dimension: 53x26mm  
Bristle length: 20mm



#### 52030 - Installation kit 2x3FLF horizontal SB BAK22

hook-in, to BAK with protective edge 12mm and 22mm  
made of galvanized sheet steel 1.5mm  
including 2 mounting plates  
color: RAL 7032 pebble gray  
equipped, wired and tested: 1 pc. Terminal block 7x2.5mm<sup>2</sup>  
3 pcs. socket FLF 3/5 T13 white 55200  
minimum floor height: BAK12=74mm; BAK22=84mm

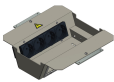

#### 52058 - Installation kit 2x8 module-BT empty BAK22 / DAK22

for modules type bticino  
mountable, to BAK and DAK with protective edge 22mm  
including 2 holding plates and 2 mounting plates  
color: RAL 7032 pebble gray  
equipped with: 1 pc. Terminal strip 9x2.5mm<sup>2</sup>  
minimum floor height: BAK12=89mm; BAK22=99mm

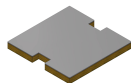

#### 51567 - Al cover visible BAK22 KM

made of aluminum 3mm, Sichseite colorless anodized,  
glued to wood raw chipboard V100 22mm.  
Dimension: 271x271x25mm

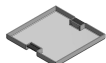

#### 51573 - Al lid with rim BAK/DAK22 BL

made of aluminum 3mm  
with edge height 22mm  
including 2 pcs. Brush outlets





## System overview

### Floor junction box BAK22 to slab formwork

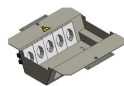

#### **52050 - Installation kit 2x5FLF vertical SB BAK22**

hook-in, to BAK with protective edge 12mm and 22mm  
including 2 mounting plates  
Color: RAL 7032 pebble gray  
equipped, wired and tested: 1 pcs. Terminal strip 9x2.5mm<sup>2</sup>  
5 pcs. socket FLF 3/5 T13 white 55200  
Minimum floor height: BAK12=89mm; BAK22=99mm



#### **52073 - Installation kit 2x8 module-LM empty BAK22 / DAK22**

for modules type Legrand Mosaic  
hangable, to BAK with protective edge 12mm and 22mm  
including 2 mounting plates  
color: RAL 7032 pebble gray  
equipped with: 1 pc. Terminal strip 9x2.5mm<sup>2</sup>  
minimum floor height: BAK12=89mm; BAK22=99mm

