

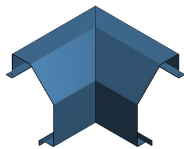

Product data sheet

58884 - Corner piece 90° inn chamfer FnW KDK 220x150



90° inside galvanized steel sheet 1.5mm  
Color: your choice  
Leg length: à 250mm

| Characteristics       |                                 |
|-----------------------|---------------------------------|
| Base Unit             | Piece                           |
| availability          | Delivery according to agreement |
| group                 | 999000                          |
| Packaging unit        | 1                               |
| country of origin     | CH                              |
| Customs tariff number | 7308.9000                       |
| Technical data        |                                 |
| Nominal mass          | 220x150                         |



## **Product data sheet**

58884 - Corner piece 90° inn chamfer FnW KDK 220x150

### **Product accessories**



## Product data sheet

58884 - Corner piece 90° inn chamfer FnW KDK 220x150

### Product systems

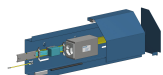

**Hinged cover channel system KDK 220x150**

Hinged cover channel 200x150 mm

